



**VESTIL MANUFACTURING CORP.**  
 2999 N. Wayne St., Angola, IN 46703  
 Ph: 260-665-7586 · Fax: 260-665-1339  
 E-mail: sales@vestil.com · Website: www.vestil.com

# OWNER'S MANUAL

**STORAGE SHED MODELS: STOR-96-G-W-1RH & STOR-912-G-W-1RH**

Introduction.....	1	STOR-96-G-W-1RH Exploded Parts Diagram & parts List.....	13
Assembly Instructions STOR-96-G-W-1RH.....	2-5	STOR-912-G-W-1RH Exploded Parts Diagram & Parts List.....	14
Assembly Instructions STOR-912-G-W-1RH.....	6-12	Limited warranty.....	15

**IMPORTANT NOTES, WARNINGS AND SAFETY INSTRUCTIONS**

Ensure that all employees understand and follow these instructions.

- ☞ Failure to read and understand this owner's manual before using or servicing constitutes a misuse of the product. All persons who will install, use, or care for this product must be familiar with this material.
- Ensure that all information / safety / warning labels stay in place and are legible.
- ◆ Do not perform any modifications to the unit without the manufacturer's approval. Failure to receive authorization for changes to the equipment could void the warranty.
- ◆ Maintenance and repairs are to be done only by personnel qualified to perform the required work. Consideration will not be given for warranty repair charges without prior written authorization by the manufacturer.



STOR-96-G-W-1RH



STOR-912-G-W-1RH

**RECEIVING INSTRUCTIONS**

It is possible that this product could incur damage during transit.

Inspect the unit closely when it arrives. *If you see evidence of damage or rough handling to either the packaging or to the product when it is being unloaded, **immediately** make a note of it on the Bill Of Lading!*

It is important that you remove the product's packaging upon its arrival to ensure that there is no concealed damage or to enable a timely claim with the carrier for freight damage.

Also verify that the product and its specifications are as ordered.

**TOOLS REQUIRED**

- 7/16" socket or wrench
- 1/2" socket or wrench
- 5/16" nut driver for drill
- Level
- Eye/Hand protection advised

Note - At least two people required to assemble this product; three suggested

## **ASSEMBLY INSTRUCTIONS**

*Review the bill of materials located on page 13. Unpack all materials and verify quantities before starting.*

*Consult the factory in the event there are any questions or problems at the time of installation, or for information regarding optional features not covered by the owner's manual.*

-----

### **SINGLE STORAGE UNIT MODEL STOR-96-G-W-1RH**

#### **Step 1**



Place wooden floor on clean and level surface.

#### **Step 2**



Position back wall as shown above.

**Step 3**



Secure back wall to the wooden floor using the 1/4" X 2" lag bolts into the 5 predrilled holes. Continue holding back wall until at least two walls are connected together and lagged to the wooden floor.

**Step 4**

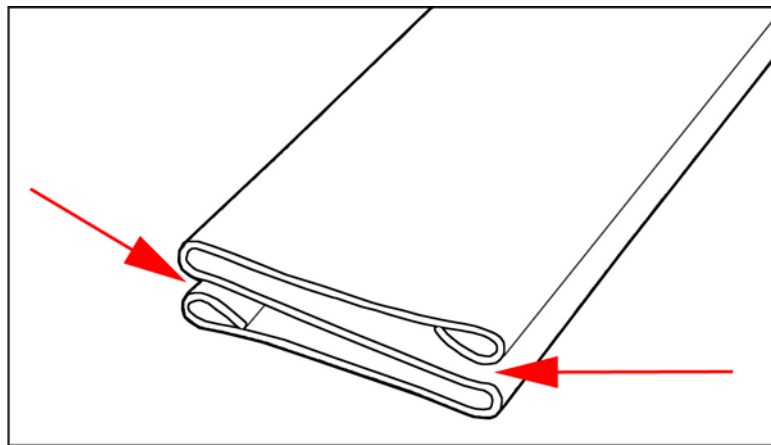

**Lockstrip Illustration**

Install lockstrip to both vertical ends of back wall.

**Step 5**



Install one side wall by inserting into the lockstrip just installed on the back wall vertical end.



**Step 6**

Install 2<sup>nd</sup> side wall using foot to hold bottom of wall while inserting into lockstrip.

**Step 7**

Secure both side walls to the wooden floor using 1/4" X 2" lag bolts into the 5 predrilled holes located at the bottom of each side wall.

**Step 8**

Install lockstrips (2) on side walls; then insert front wall with door assembly into lockstrips (door not shown in photo above). Install lag bolts, 1/4" X 2" lag bolts, utilizing the 5 predrilled holes to secure front wall to the wooden floor.

**Step 9**



Place roof on top of the storage unit walls and simply pull it down into the channels until it bottoms out.

**Step 10**



Secure roof to the front and back walls with 8pc 1" long self-tapping screws. (4 pcs. per wall) These holes are not predrilled. Space screws evenly across both walls.

**Step 11**



Fully assembled shed

**DOUBLE STORAGE UNIT MODEL STOR-912-G-W-1RH**

**Step 1**



Install joint, 2"x 4"s, to 9 foot side of each wooden floor,  $\frac{3}{4}$ " down from top using 6pc – 3" long wood screws, as evenly spaced as possible per side.

**Step 2**



Pre-Cut Spacers

Place wooden floors with 2"X4" joints together on a level surface and position pre-cut spacers as shown.

**Step 3**



Using 20pc of 2" long wood screws fasten down the spacer strips directly over the 2"X4" joints. Evenly space wood screws along entire length of spacer strip.



**Step 4**

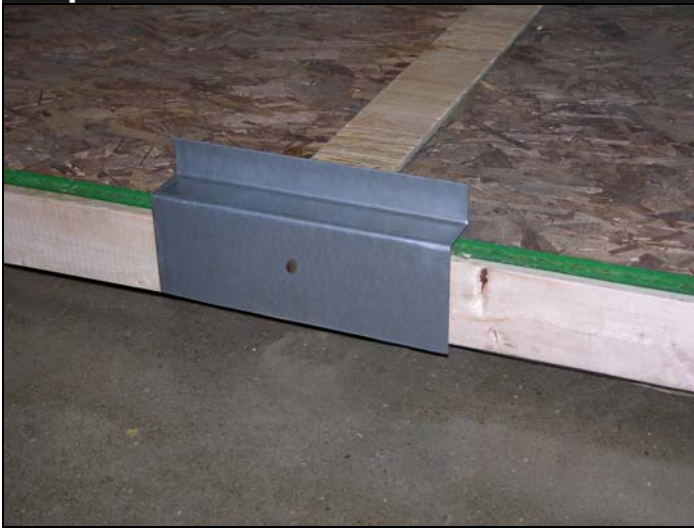

Install Face Joint to the center of the two joined wooden floors using 2pc of ¼" X 2" lag bolts – one bolt per face joint on each side for the wooden floors.

**Step 5**



Begin assembly with wooden floors on clean level surface.

**Step 6**



Position back wall as shown above.

**Step 7**



Secure back wall to the wooden floor using ¼"X 2" lag bolts into the 5 predrilled holes. Continue holding back wall until at least two walls are connected together and lagged to the wooden floor.

**Step 8**

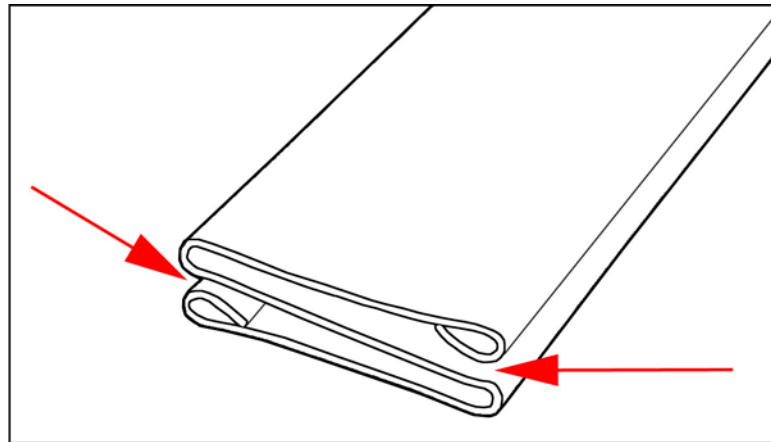

**Lockstrip Illustration**

Install lockstrip to both vertical ends of back wall.

**Step 9**



Install one side wall by inserting into the lockstrip just installed on the back wall vertical end.



**Step 10**



Install 2<sup>nd</sup> sidewall using foot to hold bottom of the side wall while inserting it into lockstrip on opposite end of the back wall.

**Step 11**



Secure both side walls to the wooden floor using 1/4" X 2" lag bolts into the 5 predrilled holes on each side.

**Step 12**



Install lockstrip on end of side wall and then install Side Fill Panel, as seen above on right hand side (see step 13 for installation)

**Step 13**

Insert Side Fill Panel into lockstrip and add lockstrip to other side of the Side Fill Panel. Repeat this step for other side of storage unit.

**Step 14**

Install next side wall panel. Repeat on other side wall. Then install 10pc 1/4"X2" lag bolts to secure walls to wooden floor. 5 predrilled holes at the bottom of each wall.

**Step 15**

Install lockstrips (2) on each side wall; then insert front wall with door assembly into lockstrips (door not shown in photo above). Install 5pc of 1/4"X2" lag bolts into predrilled holes to secure front wall to the wooden floor.

**Step 16**

Place roof on top of the storage unit walls and simply pull it down into the channels until it bottoms out. Repeat with second roof piece.

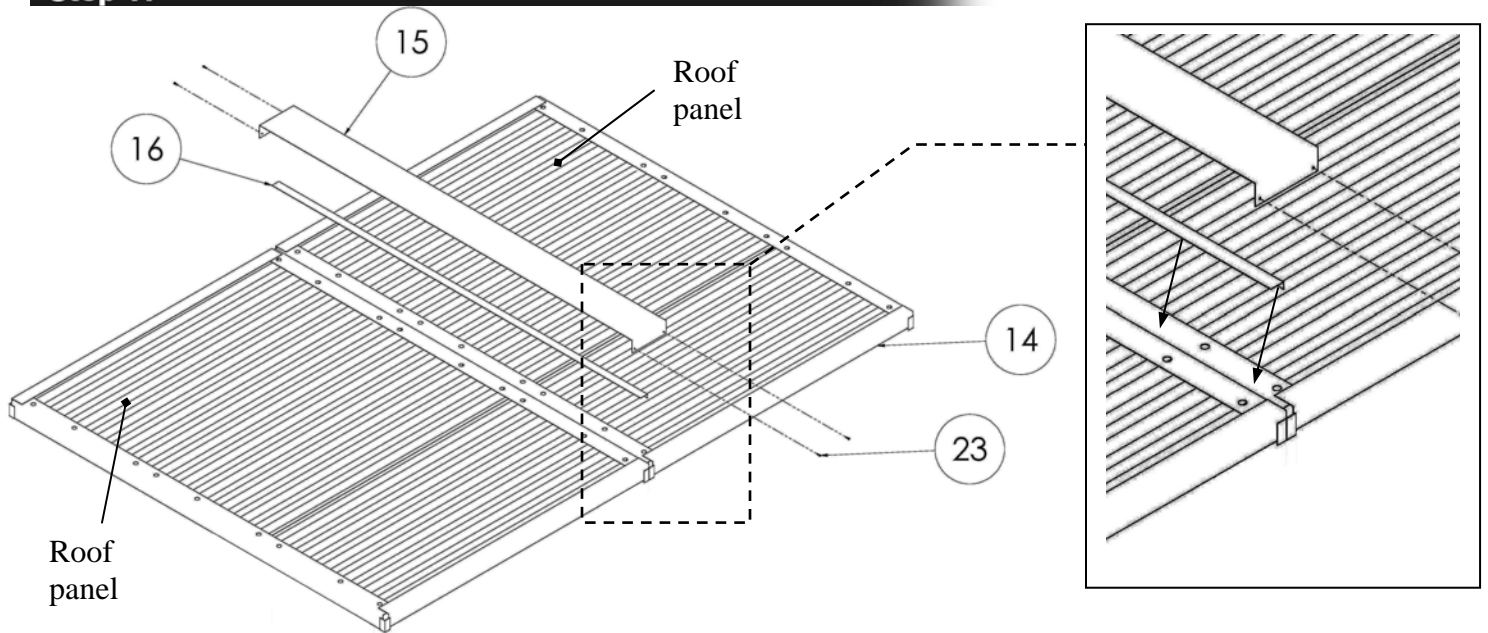
**Step 17**

Install the formed roof angle piece (16) between the roof panels; then install the roof seam cover plate (15) on top of the angle piece.

**NOTE:** Some shed kits will combine parts 15 & 16 into a single welded cover plate. Insert the projection on the underside of the welded cover plate into the space between the roof panels.

**Step 18**

Secure the roof seam cover plate to roof and walls with 4 self-tapping screws. (2 screws at each end of the cover plate)



**Step 19**



Secure roof to front and back walls with 16pc 1” long self-tapping screws.(4pc per wall) These holes are not predrilled. Space screws evenly.

The assembly process is now finished:



Fully assembled shed.

STOR-96-G-W-1RH EXPLODED PARTS DIAGRAM

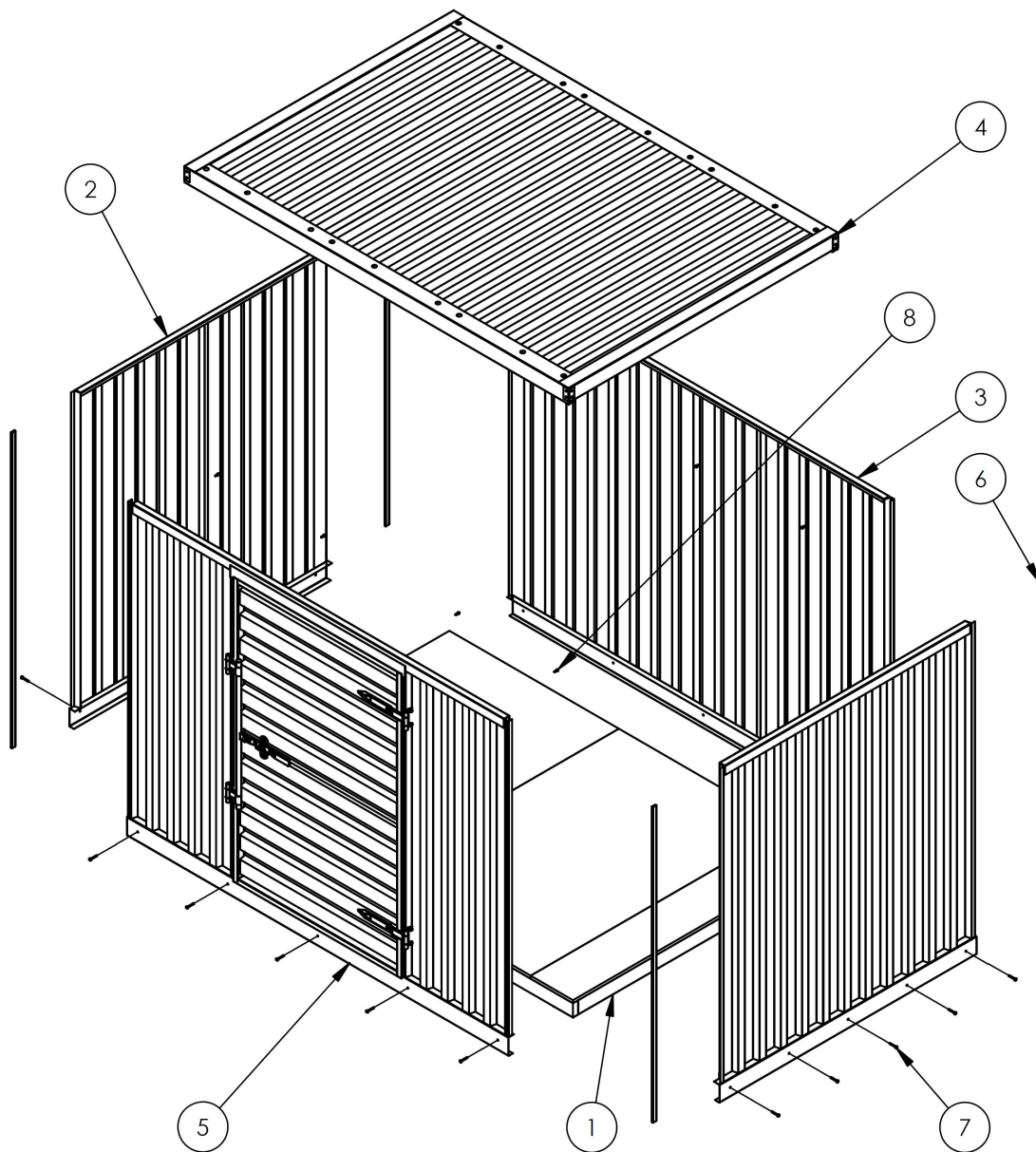

Item No.	Part No.	Description	Quantity
1	41-514-017	Assembly, wood floor base, single	1
2	41-514-013	Weldment, side wall subassembly	2
3	41-514-014	Weldment, back wall subassembly	1
4	41-514-016	Weldment, roof wall subassembly	1
5	41-514-048	Assembly, front wall	1
6	41-037-003	Lock strip	4
7	22061	Bolt, lag bolt	20
8	31806	Screw, self-tapping screw	8

STOR-912-G-W-1RH EXPLODED PARTS DIAGRAM

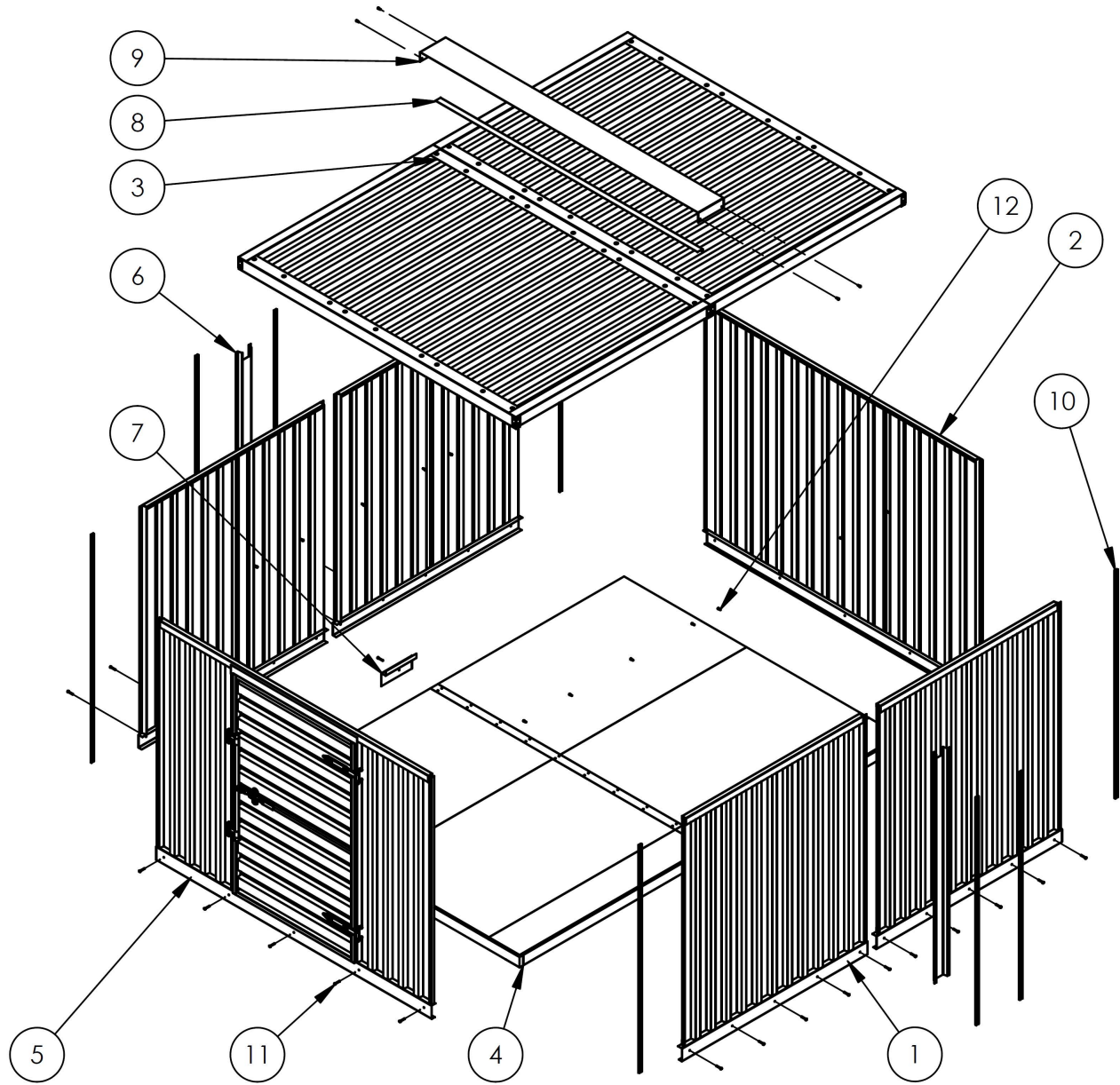

Item No.	Part No.	Description	Quantity
1	41-514-013	Formed floor seam cover plate	4
2	41-514-014	Side wall frame assembly	1
3	41-514-016	Rear wall frame assembly	2
4	41-514-018	Door frame assembly	1
5	41-514-048	Door	1
6	41-014-032	Lock/latch bar assembly	2
7	41-014-030	¼ in. – 20 UNC x 1 in. zinc-plated carriage bolt	2
8	41-014-027	9/16 in. Zinc-plated USS flat washer	1
9	41-014-026	Side wall frame connector	1
10	41-037-003	Lock strip	8
11	22061	¼ in. x 2 in. zinc-plated hex lag bolt	32
12	31806	Screw, self-tapping screw	20

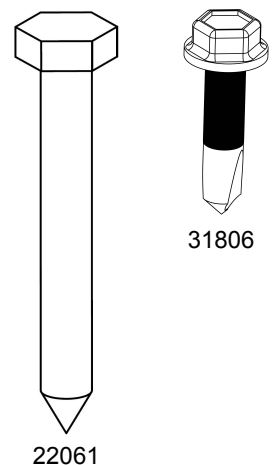



**LIMITED WARRANTY**

Vestil Manufacturing Corporation ("Vestil") warrants this product to be free of defects in material and workmanship during the warranty period. *Our warranty obligation is to provide a replacement for a defective original part if the part is covered by the warranty, after we receive a proper request from the warrantee (you) for warranty service.*

**Who may request service?**

Only a warrantee may request service. *You are a warrantee if* you purchased the product from Vestil or from an authorized distributor AND Vestil has been fully paid.

**What is an "original part"?**

An original part is a part used to make the product as shipped to the warrantee.

**What is a "proper request"?**

A request for warranty service is proper if Vestil receives: 1) a photocopy of the Customer Invoice that displays the shipping date; AND 2) a written request for warranty service including your name and phone number. Send requests by any of the following methods:

Mail  
Vestil Manufacturing Corporation  
2999 North Wayne Street, PO Box 507  
Angola, IN 46703

Fax  
(260) 665-1339  
Phone  
(260) 665-7586

Email  
sales@vestil.com

In the written request, list the parts believed to be defective and include the address where replacements should be delivered.

**What is covered under the warranty?**

After Vestil receives your request for warranty service, an authorized representative will contact you to determine whether your claim is covered by the warranty. Before providing warranty service, Vestil may require you to send the entire product, or just the defective part or parts, to its facility in Angola, IN. The warranty covers defects in the following *original* dynamic components: motors, hydraulic pumps, electronic controllers, switches and cylinders. It also covers defects in *original* parts that wear under normal usage conditions ("wearing parts"): bearings, hoses, wheels, seals, brushes, batteries, and the battery charger.

**How long is the warranty period?**

The warranty period for original dynamic components is 90 days. For wearing parts, the warranty period is 90 days. The warranty periods begin on the date when Vestil ships the product to the warrantee. If the product was purchased from an authorized distributor, the periods begin when the distributor ships the product. Vestil may, at its sole discretion, extend the warranty periods for products shipped from authorized distributors by up to 30 days to account for shipping time.

**If a defective part is covered by the warranty, what will Vestil do to correct the problem?**

Vestil will provide an appropriate replacement for any *covered* part. An authorized representative of Vestil will contact you to discuss your claim.

**What is not covered by the warranty?**

1. Labor;
2. Freight;
3. Occurrence of any of the following, which automatically voids the warranty:
  - Product misuse;
  - Negligent operation or repair;
  - Corrosion or use in corrosive conditions;
  - Inadequate or improper maintenance;
  - Damage sustained during shipping;
  - Accidents involving the product;
  - Unauthorized modifications: DO NOT modify the product IN ANY WAY without first receiving written authorization from Vestil. Modification(s) might make the product unsafe to use or might cause excessive and/or abnormal wear.

**Do any other warranties apply to the product?**

Vestil Manufacturing Corp. makes no other express warranties. All implied warranties are disclaimed to the extent allowed by law. Any implied warranty not disclaimed is limited in scope to the terms of this Limited Warranty.

